



PodCom-S USER GUIDE

PLUG INTO THE FUTURE OF TECHNOLOGY



ARNOUSE DIGITAL
DEVICES CORPORATION

Table of Contents

Section 1	Receiving Your PodCom-S	4
Section 1.1	What's in the Box?	4
Section 2	PodCom-S Preparation	5
Section 2.1	Preparing For Your PodCom-S	5
Section 2.2	Inserting Your BioDigitalPC®	6
Section 2.2.1	Opening the PodCom-S Front Door	6
Section 2.2.2	Insert the BioDigitalPC®s	6
Section 2.2.3	Make Sure to Close the Door Tightly!!!	6
Section 2.3	Connect Power and Rear Data Cable	7
Section 2.3.1	Connect 5-pin Mil-5015 power cable	7
Section 2.3.2	Connect the Mil Spec Data Cable	7
Section 2.4	Open Front Cover For USB and DP Ports	8
Section 2.4.1	Remove the front right cover to expose USB 2.0 ports and a MiniDP port	8
Section 3	PodCom-S Overview	9
Section 3.1	PodCom-S Front Overview	9
Section 3.2	PodCom-S Rear Overview	10

How to Read this Document

This manual details installation of the PodCom-S, the components inside of the PodCom-S and its notable features.

Installations will be supported by ADDC. Unless otherwise specified, all instructions provided in this manual will assume that a user is a trained technician.

Notes, Important Information & Warnings

 You will see this icon throughout the manual intended to point out warnings, important information, and briefly explain any new terminology.

Section 1.0 - Receiving Your PodCom-S

Section 1.1 - What's in the Box?



PodCom-S Dock



Mil Spec circular connector
Cable with:
(3) 10/100 ethernet ports
(1) 1GB ethernet port
(1) USB 2.0
(1) RS232 serial port



5-pin Mil-5015 circular
connector power cable.

Section 2 - PodCom-S Preparation

Section 2.1 - Preparing For Your PodCom-S

Temperature Considerations

Your PodCom-S is designed to operate fanless at room temperature with its self-contained cooling.

⚠ To prevent improper cooling of equipment, make sure the door is always closed whenever the BioDigitalPC® is running.

Section 2.2 - Inserting Your BioDigitalPC®

BioDigitalPC®s are hot-pluggable, meaning technicians do not need to remove power to begin adding or removing them.

Section 2.2.1 - Opening the PodCom-S Front Door:



Section 2.2.2 - Insert BioDigitalPC® :



You must push the BioDigitalPC® up as you close the door so that the door pad shown above won't interfere with door's normal operation.

Section 2.2.3 - Make Sure To Close The Door Tightly!!!:



This step is really important make sure the door is always tightly close!!!

⚠ Make sure the PodCom-S door is always closed when running a BioDigitalPC®, when the door is firmly closed it pushes the BioDigitalPC®s against the heat pad which in turn transfers the heat to the chassis' heat sink. Omission to close the PodCom-S' door may cause the BioDigitalPC® to overheat.

⚠ Only trained technicians are authorized to work beneath the PodCom-S System Cover and access any of the components inside the system.

Section 2.3 - Connect Power and Rear Data Cable

Section 2.3.1 - Connect 5-pin Mil-5015 power cable:

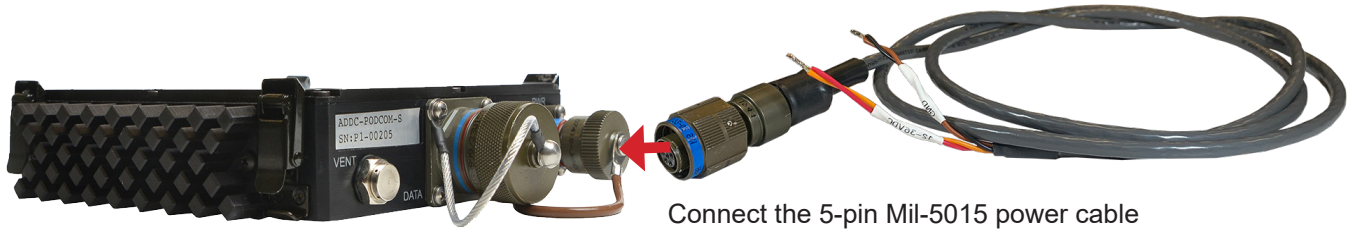

Section 2.3.2 - Connect the Mil Spec data cable:



Section 2.4 - Open Front Cover For USB and DP Ports

Section 2.4.1 - Remove the front right cover to expose USB 2.0 ports and a MiniDP port:



Remove the front right cover by loosening the two bolts on it. Once the cover is removed it will expose (2) USB 2.0 ports and a MiniDP video port.

Section 3 - PodCom-S Overview

Section 3.1 - PodCom-S front overview:

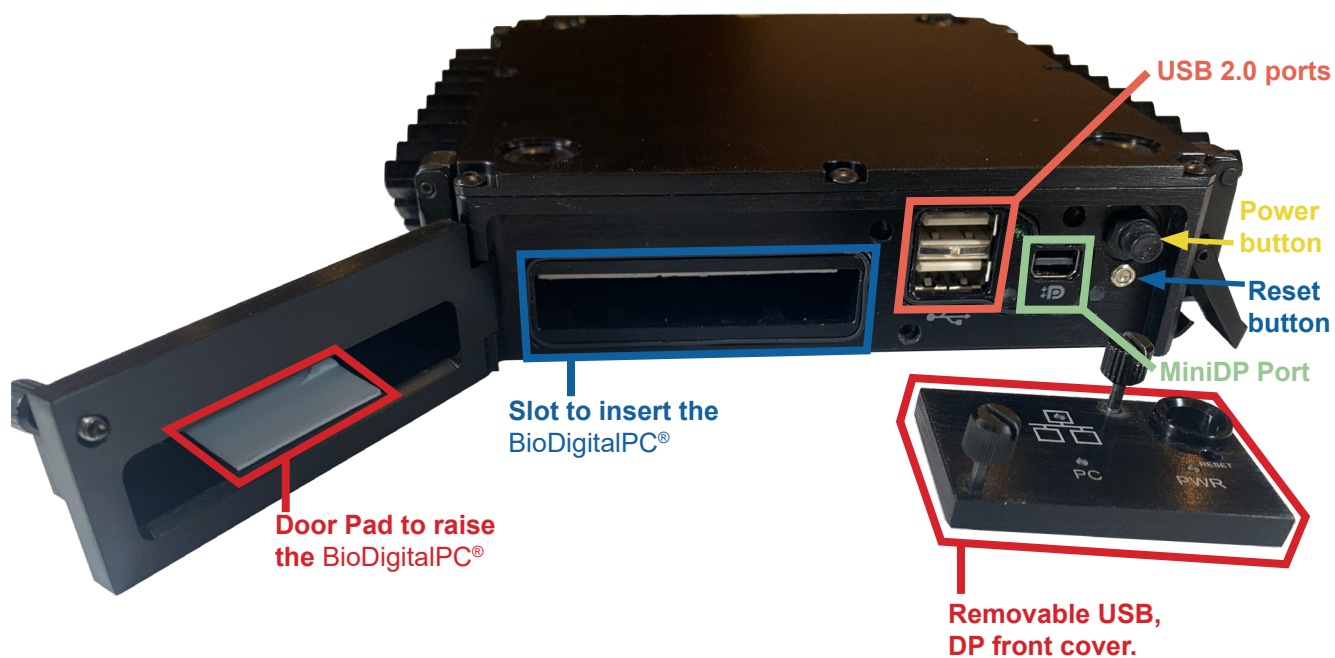

Section 3.2 - PodCom-S rear overview:

