



# INSTRUCTION MANUAL



## MDC SR-10



◀ OPEN THE CASE

◀ LIFT CLIPS



◀ POWER INPUTS

AC INPUT

DC INPUT

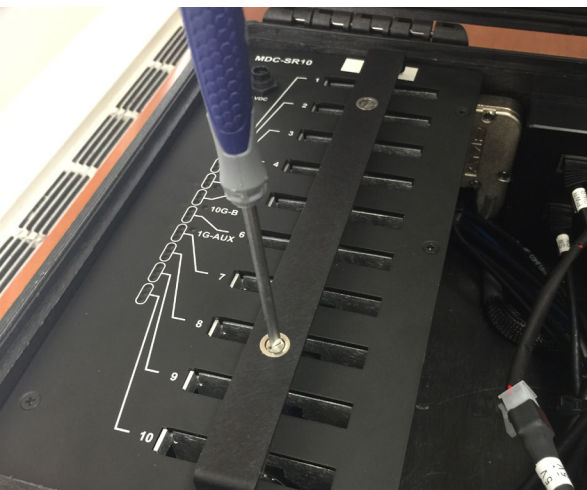

◀ REMOVING THE CARD  
HOLD-DOWNS

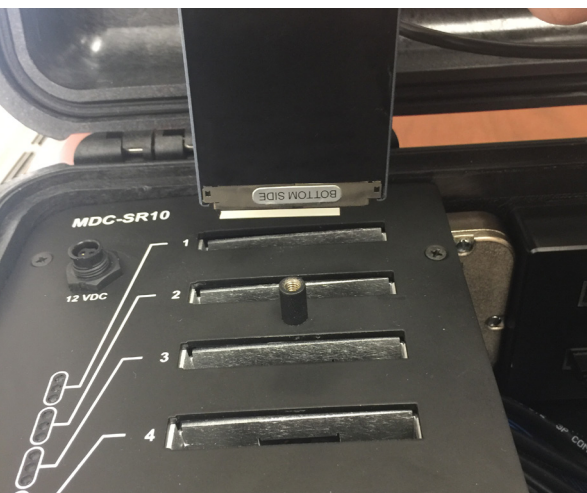

◀ INSERTING THE CARD



[serial number should be right side up]



POWER BUTTON ▶

VOLTAGE INDICATOR

POWER BUTTON



THE NETWORKS LOCATED ON THE BACK OF THE MDC SR-10 ▶

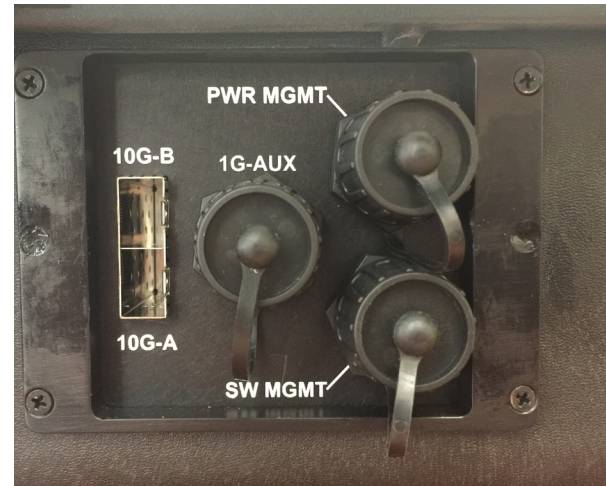

◀ 1G- AUX

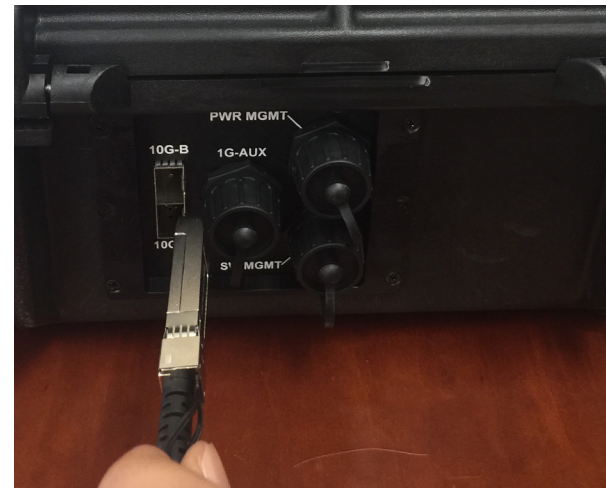

10G- A ▶



◀ POWER MANAGEMENT



SWITCH MANAGEMENT ▶



◀ CONNECT THE 12VDC  
DISPLAY CABLE

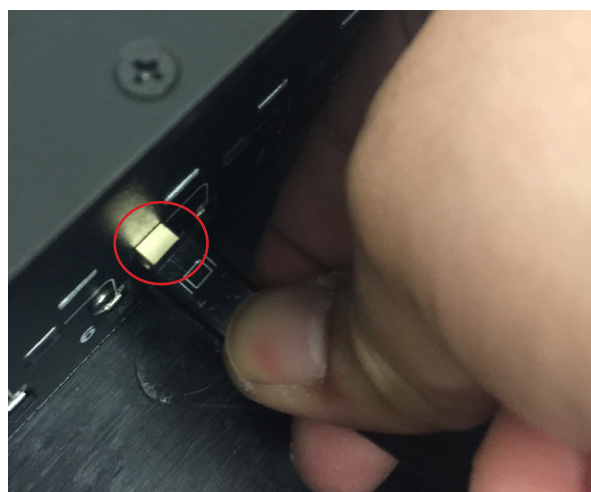

◀ CONNECT THE  
MINIDP TO DISPLAY

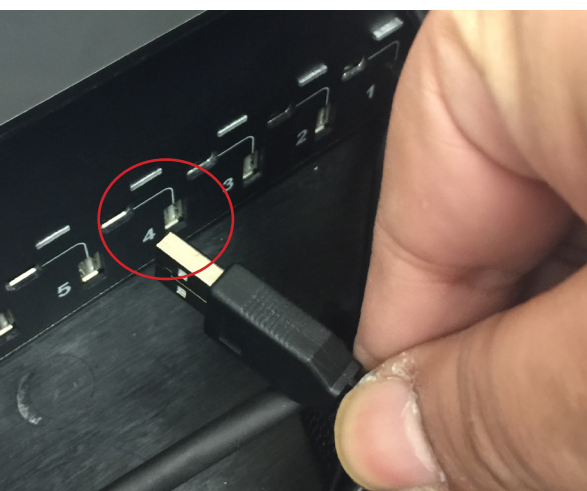

◀ CONNECT THE MOUSE  
AND KEYBOARD  
[USB HUB NOT INCLUDED]

## BASIC LOGIN FOR SWITCH GUI ▶

REFER TO INSIDE STICKER FOR  
MANAGEMENT INFORMATION

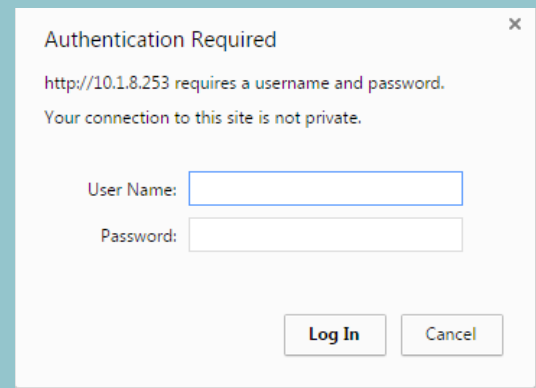

Authentication Required

<http://10.1.8.253> requires a username and password.  
Your connection to this site is not private.

User Name:

Password:

## POWER MANAGEMENT GUI ▶

REFER TO INSIDE STICKER FOR  
MANAGEMENT INFORMATION

